



Midra
Trustable always



The Trustable Caster Supplier

Product Presentation 2024

O Series 230–500 kg



Features

- § Blue high resilience (hi-res) rubber, grey rubber, polyurethane (PU), or hard nylon wheels.
- § Swivel or fixed plate zinc plated Core Coat™ forks with or without total brake or direction lock. Core Coat™ lacquer provides best quality corrosion protection, with no white or red rust after 150 hours of salt spray testing.
- § Made in Australia.

Wheels



HBR*1	OBQ	HSR*1	HUR*	ONR*
Blue hi-res rubber, roller bearing, optional thread guard ²	Blue hi-res rubber, round profile, precision bearing	Grey rubber, roller bearing, optional thread guard ²	PU on nylon, roller bearing	Hard nylon, roller bearing

Wheel	Max load (kg)	Diameter x tread (mm)	Hub x bore ³ (mm)	Bore—no bush (mm)
HBR1502	230	150 x 28	60 x 12.7	20
HBR2002	250	200 x 28	60 x 12.7	20
OBQ100	300	100 x 50	60 x 12.7	20
OBQ125	350	125 x 50	60 x 12.7	20
OBQ150	400	150 x 50	60 x 12.7	20
OBQ200	400	200 x 50	60 x 12.7	20
HSR2002	250	200 x 50	60 x 12.7	20
HUR100	400	100 x 40	60 x 12.7	20
HUR125	400	125 x 40	60 x 12.7	20
HUR1502	450	150 x 40	60 x 12.7	20
HUR200	500	200 x 48	60 x 12.7	20
ONR100	400	100 x 40	60 x 12.7	20
ONR125	400	125 x 40	60 x 12.7	20
ONR150	450	150 x 40	60 x 12.7	20
ONR200	500	200 x 40	60 x 12.7	20

- * Wheels also available with plain bearings—HBA, HSA, HUA, ONA.
¹ HBR, HBA, HSR, HSA wheels in a 200 mm diameter are not compatible with total brake fork.
² For optional thread guards, add **G** to the end of wheel code.
³ Bore size is reduced to 12.7 mm with a spacer before fitting into a fork.

Forks



OZP	OZPTB1	OZPDL	HZF
Plate with swivel	Plate with swivel and total brake	Plate with swivel and direction lock	Fixed plate, no swivel

Forks	Wheel size (mm)	Mount height (mm)	Turning radius (mm)
OZP/HZF4	100	138	96
	125	162	109
	150	189	121
	200	239	152
OZPTB/OZPDL	100	138	140
	125	162	140
	150	189	140
	200	239	162

Fork mounts

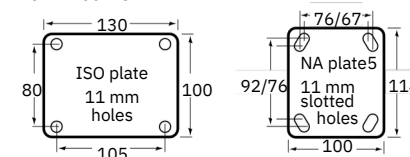

- ⁴ HZF—fixed plate has no turning radius.
⁵ North American plate. Add **N** to the end of fork code to purchase (eg. HBR150/OZPNTB).

Order codes

Wheel code	Fork code	Castor code
HBR150	O150ZP	HBR150/OZP
	H150ZF	HBR150/HZF
	O150ZPTB	HBR150/OZPTB
	O150ZPDL	HBR150/OZPDL
HBR200	O200ZP	HBR200/OZP
	H200ZF	HBR200/HZF
	O200ZPDL	HBR200/OZPDL
HSR200	O200ZP	HSR200/OZP
	H200ZF	HSR200/HZF
	O200ZPDL	HSR200/OZPDL
HUR100	O100ZP	HUR100/OZP
	H100ZF	HUR100/HZF
	O100ZPTB	HUR100/OZPTB
	O100ZPDL	HUR100/OZPDL
HUR125	O125ZP	HUR125/OZP
	H125ZF	HUR125/HZF
	O125ZPTB	HUR125/OZPTB
	O125ZPDL	HUR125/OZPDL
HUR150	O150ZP	HUR150/OZP
	H150ZF	HUR150/HZF
	O150ZPTB	HUR150/OZPTB
	O150ZPDL	HUR150/OZPDL
HUR200	O200ZP	HUR200/OZP
	H200ZF	HUR200/HZF
	O200ZPTB	HUR200/OZPTB
	O200ZPDL	HUR200/OZPDL

Wheel code	Fork code	Castor code
OBQ100	O100ZP	OBQ100/OZP
	H100ZF	OBQ100/HZF
	O100ZPTB	OBQ100/OZPTB
	O100ZPDL	OBQ100/OZPDL
OBQ125	O125ZP	OBQ125/OZP
	H125ZF	OBQ125/HZF
	O125ZPTB	OBQ125/OZPTB
	O125ZPDL	OBQ125/OZPDL
OBQ150	O150ZP	OBQ150/OZP
	H150ZF	OBQ150/HZF
	O150ZPTB	OBQ150/OZPTB
	O150ZPDL	OBQ150/OZPDL
OBQ200	O200ZP	OBQ200/OZP
	H200ZF	OBQ200/HZF
	O200ZPTB	OBQ200/OZPTB
	O200ZPDL	OBQ200/OZPDL

Wheel code	Fork code	Castor code
ONR100	O100ZP	ONR100/OZP
	H100ZF	ONR100/HZF
	O100ZPTB	ONR100/OZPTB
	O100ZPDL	ONR100/OZPDL
ONR125	O125ZP	ONR125/OZP
	H125ZF	ONR125/HZF
	O125ZPTB	ONR125/OZPTB
	O125ZPDL	ONR125/OZPDL
ONR150	O150ZP	ONR150/OZP
	H150ZF	ONR150/HZF
	O150ZPTB	ONR150/OZPTB
	O150ZPDL	ONR150/OZPDL
ONR200	O200ZP	ONR200/OZP
	H200ZF	ONR200/HZF
	O200ZPTB	ONR200/OZPTB
	O200ZPDL	ONR200/OZPDL



H Series 400–600 kg



Features

- § Blue high resilience (hi-res) rubber, cast iron, hard nylon or polyurethane (PU) wheels with a 20 mm bore diameter, reduced to 12.7 mm with an axle bush.
- § Swivel or fixed plate zinc plated Core Coat™ forks with or without total brake or direction lock. Core Coat™ lacquer provides best quality corrosion protection, with no white or red rust after 150 hours of salt spray testing.
- § Made in Australia.

Fork mounts

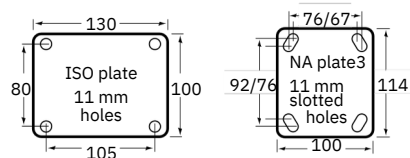

Wheels



Wheel	Material	Bearing
OBQ*	Blue hi-res rubber, round profile, precision bearing	
WCI1	Cast iron, plain bearing	
WNQ4	Hard nylon, precision bearing	
WUQ4	PU, precision bearing	

Wheel	Max load (kg)	Diameter x tread (mm)	Hub x bore (mm)	Bore—no bush (mm)
OBQ150	400	150 x 50	60 x 12.7	20
OBQ200	400	200 x 50	60 x 12.7	20
WCI150	400	150 x 50	60 x 12.7	20
WNQ150	600	150 x 40	60 x 12.7	20
WNQ200	600	200 x 40	60 x 12.7	20
WUQ150	600	150 x 40	60 x 12.7	20
WUQ200	600	200 x 40	48 x 12.7	20

Forks



Fork	Description
HZP	Plate with swivel
HZPTB1	Plate with swivel and total brake
HZPDL*	Plate with swivel and direction lock
HZF	Fixed plate, no swivel

Forks	Wheel size (mm)	Mount height (mm)	Turning radius (mm)
HZP/HZF2	150	189	121
	200	239	155
HZPTB/HZPDL	150	189	165
	200	239	165

Order codes

Wheel code	Fork code	Castor code
OBQ150	H150ZP	OBQ150/HZP
	H150ZF	OBQ150/HZF
	H150ZPTB	OBQ150/HZPTB
OBQ200	H200ZP	OBQ200/HZP
	H200ZF	OBQ200/HZF
	H200ZPTB	OBQ200/HZPTB
WCI150	H150ZP	WCI150/HZP
	H150ZF	WCI150/HZF
	H150ZPDL	WCI150/HZPDL
WNQ150	H150ZP	WNQ150/HZP
	H150ZF	WNQ150/HZF
	H150ZPTB	WNQ150/HZPTB
	H150ZPDL	WNQ150/HZPDL
WNQ200	H200ZP	WNQ200/HZP
	H200ZF	WNQ200/HZF
	H200ZPTB	WNQ200/HZPTB
	H200ZPDL	WNQ200/HZPDL
WUQ150	H150ZP	WUQ150/HZP
	H150ZF	WUQ150/HZF
	H150ZPTB	WUQ150/HZPTB
	H150ZPDL	WUQ150/HZPDL
WUQ200	H200ZP	WUQ200/HZP
	H200ZF	WUQ200/HZF
	H200ZPTB	WUQ200/HZPTB
	H200ZPDL	WUQ200/HZPDL

* OBQ wheel is not compatible with direction lock fork.

¹ WCI wheel is not compatible with total brake fork.

² HZF—fixed plate has no turning radius.

³ North American plate. Add **N** to the end of fork code to purchase (eg. OBQ150/HZPNTB).

⁴ WNQ and WUQ wheels have a 48 mm hub when not used in conjunction with reducers and spacers (relevant to 200 mm wheels only).

H Series scaffold 360–500 kg

Features

- § Castors are branded with maker’s name, and Safe Working Load (SWL).
- § Supplied with a test certificate validating compliance to Australian Standards (important for risk management documentation).
- § The static collapse load exceeds three times the working load (certificate available).
- § Wheels 150 mm (6") and 200 mm (8") diameter to safely pass over obstacles without snagging and causing scaffold to tip.
- § The stem of the castor is 150 mm (6") long, with not more than 3 mm (1/8") of clearance to tube.
- § A means is provided for fixing castor to tube, so it will not fall out when lifted.
- § An effective wheel/swivel brake is fitted to ensure maximum stability.
- § Sockets are to suit 48.3 mm OD tube, while spigots (solid stems) are to suit 38.5 mm ID tube.
- § Core Coat™ lacquer provides best quality corrosion protection (150 hours of salt spray test).
- § For wheel information see 'O Series' on page 22.



Mount type	Wheel diameter (mm)	Max load (kg)	Castor code	Mount code
  <p><i>Socket mounting to fit over tubes.</i></p>	HUR wheel in zinc plated fork with total brake, and 51 mm socket mount to fit over 48.3 mm tubes.			
	150	360	HUR150/HZHTB	SC08
	200	500	HUR200/HZHTB	SC13
  <p><i>Solid stem with fully welded cup.</i></p>	HUR wheel in zinc plated fork with total brake, and 38 mm solid stem with fully welded cup. Suits 38.5 mm ID tube.			
	15	36	HUR150/HZPTB	SC62
	0	0	HUR200/HZPTB	SC15
	20	50		
	0	0		
  <p><i>Stem mounting to fit into tubes.</i></p>	HUR wheel in zinc plated fork with total brake, and 38 mm stem mount to fit into tubes. Suits 38.5 mm ID tube.			
	15	36	HUR150/HZHTB	SC30
	0	0	HUR200/HZHTB	SC11
	20	50		
	0	0		
  <p><i>ISO plate 130 x100 mm.</i></p>	HUR wheel in zinc plated fork with total brake, and ISO plate (130 x 100 mm).			
	15	36	HUR150/HZPTB	SC61
	0	0	HUR200/HZPTB	SC18
	20	50		
	0	0		

W Series 500–750 kg



Features

- SS Cast iron, hard nylon or polyurethane (PU) wheels.
- Swivel or fixed plate zinc forks with or without total brake.

Wheels



Wheel	Material
WCI	Cast iron, plain bearing
WNQ	Hard nylon, precision bearing
WUQ	PU, precision bearing
XUQ	PU on cast iron, precision bearing

Wheel	Max load (kg)	Diameter x tread (mm)	Hub x bore (mm)	Bore—no bush (mm)
WCI150	500	150 x 50	60 x 12.7	20
WNQ150	600	150 x 40	60 x 12.7	20
WUQ150	600	150 x 40	60 x 12.7	20
XUQ150	750	152 x 50	62 x 12.7	20

Forks



Fork	Description
WZP	Plate with swivel
WZPTB	Plate with swivel and total brake
WZF	Fixed plate, no swivel

Forks	Wheel size (mm)	Mount height (mm)	Turning radius (mm)
WZP/WZF*	150	194	130
WZPTB	150	194	176

Fork mount

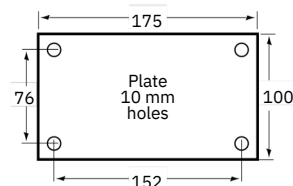

* WZF—fixed plate has no turning radius

Order codes

Wheel code	Fork code	Castor code
WCI150	W150ZP	WCI150/WZP
	W150ZF	WCI150/WZF
	W150ZPTB	WCI150/WZPTB
WNQ150	W150ZP	WNQ150/WZP
	W150ZF	WNQ150/WZF
	W150ZPTB	WNQ150/WZPTB
WUQ150	W150ZP	WUQ150/WZP
	W150ZF	WUQ150/WZF
	W150ZPTB	WUQ150/WZPTB
XUQ150	W150ZP	XUQ150/WZP
	W150ZF	XUQ150/WZF
	W150ZPTB	XUQ150/WZPTB

Dumper bin sets

Castor sets comprising two fixed and two swivel castors can be purchased for dumper bin applications. Please note that as rubbish trucks often drop dumper bins after tipping, using these castors in such applications reduce the warranty period to six months.

Wheel code	Order code
WCI150	SETDUMPERWCI
WNQ150	SETDUMPERWNQ
WUQ150	SETDUMPERWUQ
XUQ150	SETDUMPERXUQ

X Series 450–1000 kg



Features

- § Cast iron or polyurethane (PU) on cast iron wheels.
- Swivel and fixed plate zinc forks with wheel brake or direction lock.
- § Kingpin construction.

Fork mount

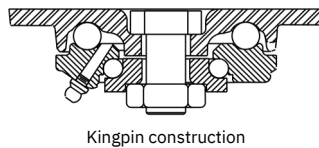
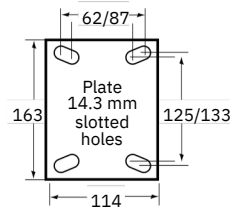

Spare parts: Brakes and directional locks

Spare part retrofit brake kit for 100 mm castor	SPBRKX100BR
Spare part retrofit brake kit for 125 mm castor	SPBRKX125BR
Spare part retrofit brake kit for 150 mm castor	SPBRKX150BR
Spare part retrofit brake kit for 200 mm castor	SPBRKX200BR
X Series directional locking pins for 100, 125, 150 & 200 mm castors	SPBRKXDL

* Directional locking pins can be used in conjunction with wheel brakes but must be purchased as an additional retrofit item.

Wheels



XCQ
Cast iron, precision bearing



XUQ
PU on cast iron, precision bearing

Wheel	Max load (kg)	Diameter x tread (mm)	Hub x bore (mm)	Bore—no bush (mm)
XCQ100	450	102 x 48	62 x 12.7	20
XCQ125	590	127 x 48	62 x 12.7	20
XCQ150	630	152 x 48	62 x 12.7	20
XCQ200	820	203 x 50	62 x 12.7	20
XUQ100	600	102 x 50	62 x 12.7	20
XUQ125	800	127 x 50	62 x 12.7	20
XUQ150	1000	152 x 50	62 x 12.7	20
XUQ200	1000	203 x 50	62 x 12.7	20

Forks



XZP
Plate with swivel



XZPBR
Plate with swivel and wheel brake



XZPDL
Plate with swivel and direction lock



XZF
Fixed plate, no swivel

Forks	Wheel size	Mount height (mm)	Turning radius (mm)
XZP/XZPDL XZF*	100	143	95
	125	167	108
	150	193	137
	200	257	162
XZPBR	100	143	219
	125	167	242
	150	193	266
	200	257	291

Order codes

Wheel code	Fork code	Castor code
XCQ100	X100ZP	XCQ100/XZP
	X100ZF	XCQ100/XZF
	X100ZPBR	XCQ100/XZPBR
	X100ZPDL	XCQ100/XZPDL
XCQ125	X125ZP	XCQ125/XZP
	X125ZF	XCQ125/XZF
	X125ZPBR	XCQ125/XZPBR
	X125ZPDL	XCQ125/XZPDL
XCQ150	X150ZP	XCQ150/XZP
	X150ZF	XCQ150/XZF
	X150ZPBR	XCQ150/XZPBR
	X150ZPDL	XCQ150/XZPDL
XCQ200	X200ZP	XCQ200/XZP
	X200ZF	XCQ200/XZF
	X200ZPBR	XCQ200/XZPBR
	X200ZPDL	XCQ200/XZPDL
XUQ100	X100ZP	XUQ100/XZP
	X100ZF	XUQ100/XZF
	X100ZPBR	XUQ100/XZPBR
	X100ZPDL	XUQ100/XZPDL
XUQ125	X125ZP	XUQ125/XZP
	X125ZF	XUQ125/XZF
	X125ZPBR	XUQ125/XZPBR
	X125ZPDL	XUQ125/XZPDL
XUQ150	X150ZP	XUQ150/XZP
	X150ZF	XUQ150/XZF
	X150ZPBR	XUQ150/XZPBR
	X150ZPDL	XUQ150/XZPDL
XUQ200	X200ZP	XUQ200/XZP
	X200ZF	XUQ200/XZF
	X200ZPBR	XUQ200/XZPBR
	X200ZPDL	XUQ200/XZPDL

* XZF—fixed plate has no turning radius.

V Series 2000–2450 kg



Features

- § Polyurethane (PU) on cast iron, or high impact polymer wheels. Swivel or fixed plate zinc forks with or without wheel brake or direction lock.
- § Kingpinless construction.

Wheels



VUQ
PU on cast iron, precision bearing



VXQ
High impact polymer, precision bearing

Wheel	Max load (kg)	Diameter x tread (mm)	Hub x bore (mm)	Bore—no bush (mm)
VUQ200	2000	203 x 75	89 x 20	30
VUQ250	2000	254 x 75	89 x 20	30
VXQ200	2450	200 x 75	89 x 20	30
VXQ250	2450	250 x 75	89 x 20	30

Forks



VZP
Plate with swivel



VZPBR
Plate with swivel and wheel brake



VZPDL
Plate with swivel and direction lock



VZF
Fixed plate, no swivel

Forks	Wheel size	Mount height (mm)	Turning radius (mm)
VZP/VZPDL/VZF*	20	267	165
	0	318	190
VZPBR	25	267	317
	0	318	353

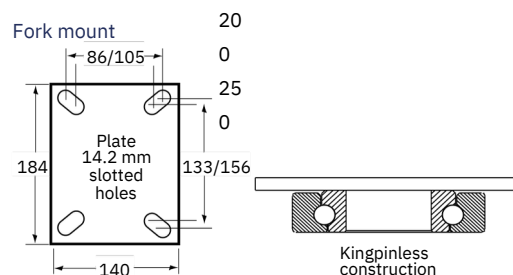

Order codes

Wheel code	Fork code	Castor code
VUQ200	V200ZP	VUQ200/VZP
	V200ZF	VUQ200/VZF
	V200ZPBR	VUQ200/VZPBR
	V200ZPDL	VUQ200/VZPDL
VUQ250	V250ZP	VUQ250/VZP
	V250ZF	VUQ250/VZF
	V250ZPBR	VUQ250/VZPBR
	V250ZPDL	VUQ250/VZPDL
VXQ200	V200ZP	VXQ200/VZP
	V200ZF	VXQ200/VZF
	V200ZPBR	VXQ200/VZPBR
	V200ZPDL	VXQ200/VZPDL
VXQ250	V250ZP	VXQ250/VZP
	V250ZF	VXQ250/VZF
	V250ZPBR	VXQ250/VZPBR
	V250ZPDL	VXQ250/VZPDL

* VZF—fixed plate has no turning radius.

Spare parts: Brakes and directional locks

Description	Order code
Spare part retrofit brake kit for 200 mm castor	SPBRKV200BR
Spare part retrofit brake kit for 250 mm castor	SPBRKV250BR
V Series directional locking pins (suits 200 mm and 250 mm castors)	BRKVDL

Directional locking pins can be used in conjunction with wheel brakes, but must be purchased as an additional retrofit item.

A Series 3000–3500 kg



Features

- § Polyurethane (PU) on cast iron wheel.
- § Swivel or fixed plate zinc forks with or without wheel brake or direction lock.
- § Kingpinless construction.

Wheels



AUQ
PU on cast iron, precision bearing

Wheel	Max load (kg)	Diameter x tread (mm)	Hub x bore (mm)	Bore—no bush (mm)
AUQ200	3000	200 x 102	109 x 30	30
AUQ250	3500	250 x 102	109 x 30	30

Forks



AZP Plate with swivel	AZPBR Plate with swivel and wheel brake	AZPDL Plate with swivel and direction lock	AZF Fixed plate, no swivel
---------------------------------	---	--	--------------------------------------

Forks	Wheel size	Mount height (mm)	Turning radius (mm)
AZP/AZPDL/AZF*	20	279	172
	0	330	197
AZPBR	25	279	317
	0	330	353

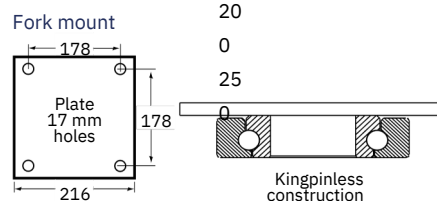

* AZF—fixed plate has no turning radius.

Order codes

Wheel code	Castor code
AUQ200 Diameter: 200 mm	AUQ200/AZP
	AUQ200/AZF
	AUQ200/AZPBR
	AUQ200/AZPDL
AUQ250 Diameter: 250 mm	AUQ250/AZP
	AUQ250/AZF
	AUQ250/AZPBR
	AUQ250/AZPDL

Spare parts: Brakes and directional locks

Description	Order code
Spare part retrofit brake kit for 200 mm castor	SPBRKA200BR
Spare part retrofit brake kit for 250 mm castor	SPBRKA250BR
A Series directional locking pin (suits 200 mm and 250 mm castors)	SPBRKADL

Directional locking pins can be used in conjunction with wheel brakes, but must be purchased as an additional retrofit item.